

4-CH U-shaped Type

NEW

■ Features

- Highly reliable 4 channel detection
- High-speed response time under 1 ms
- Reverse polarity protection circuit and output short-circuit (overcurrent) protection circuit
- IP65 protection structure (IEC standard)



⚠ Please read "Caution for your safety" in operation manual before using.



■ Specifications

Model		BUM4-40D-W-4M	BUM4-40D-W-2M/A	BUM4-40D-W-3M/A	BUM4-40D-W-4M/A	BUM4-40D-W-2M/B	BUM4-40D-W-3M/B	BUM4-40D-W-4M/B
Sensing type		Through-beam						
Sensing distance		40mm						
Sensing target		Opaque materials of min. Ø4.0mm						
Sensing CH		4 channels						
Hysteresis		Max. 1ms						
Power supply		18-35VDC ±10% (ripple P-P: max. 10%)						
Current consumption		Max. 50mA						
Light source		Infrared LED (940nm)						
Operation mode		Dark ON						
Control output		NPN open collector output (individual 4 outputs) • Load voltage: Max. 35VDC, • Load current: Max. 100mA, • Residual voltage: Max. 4V						
Protection circuit		Power reverse polarity protection circuit, output short-circuit over current protection circuit						
Indicator		Output indicator: red LED, Power indicator: green LED						
Insulation resistance		Max. 20MΩ (at 500VDC megger)						
Noise resistance		±240V the square wave noise (pulse width 1μs) by noise simulator						
Dielectric strength		1000VAC 50/60Hz for 1 min						
Vibration		1.5mm amplitude at frequency of 10to 55Hz (for 1 min) in each of X, Y, Z directions for 2 hours						
Shock		500m/s ² (approx. 50G) in each of X, Y, Z directions for 3 times						
Environment	Ambient illumination	Sunlight: Max. 11000lx , Incandescent lamp: Max. 3000lx (receiver illumination)						
	Ambient temperature	-25 to 65°C, storage: -25 to 70°C						
	Ambient humidity	35 to 85%RH, storage: 35 to 85%RH						
Protection		IP65 (IEC standards)						
Material		Case, Cover: ABS						
Cable		Ø6.0mm, 8-wire(AWG 22, core diameter: Ø1.2, number of cores: 60)						
Cable length		4m	2m	3m	4m	2m	3m	4m
Bracket		—		H01/H04 (G01)		H03/H04 (G02)		
Approval		CE						
Weight		Approx. 510g (approx. 500g)		Approx. 1.5kg (approx. 500g)				

※1: The weight is with packaging and the weight in parentheses is only unit weight.

※The temperature or humidity mentioned in Environment indicates a non-freezing or condensation environment.

■ Operation Mode

Operaiton mode	Dark ON
Receiver operation	Received light Interrupt light
Operation indicator (LED)	ON OFF
Transistor output	ON OFF

When shorting control output terminal or flow over the rated current, protection circuit operates and normal signal is not output.

(A) Photoelectric Sensors
(B) Fiber Optic Sensors
(C) Door/Area Sensors
(D) Proximity Sensors
(E) Pressure Sensors
(F) Rotary Encoders
(G) Connectors/ Connector Cables/ Sensor Distribution Boxes/ Sockets
(H) Temperature Controllers
(I) SSRs / Power Controllers
(J) Counters
(K) Timers
(L) Panel Meters
(M) Tacho / Speed / Pulse Meters
(N) Display Units
(O) Sensor Controllers
(P) Switching Mode Power Supplies
(Q) Stepper Motors & Drivers & Controllers
(R) Graphic/ Logic Panels
(S) Field Network Devices
(T) Software

BUM Series

■ Dimensions

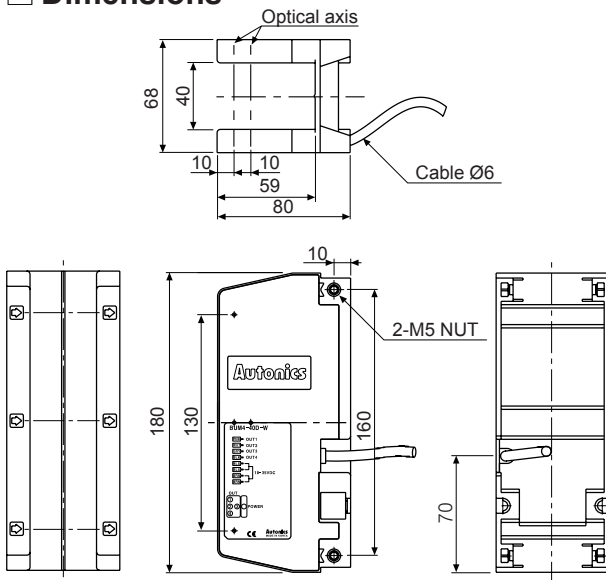

○ Bracket

(unit: mm)

● H01

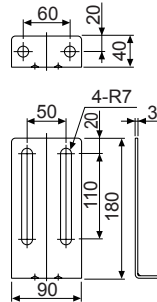

● H03

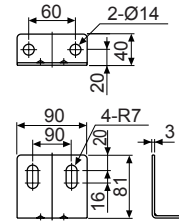

● H04

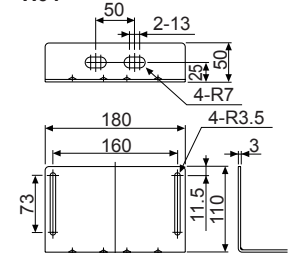

■ Control Output Diagram

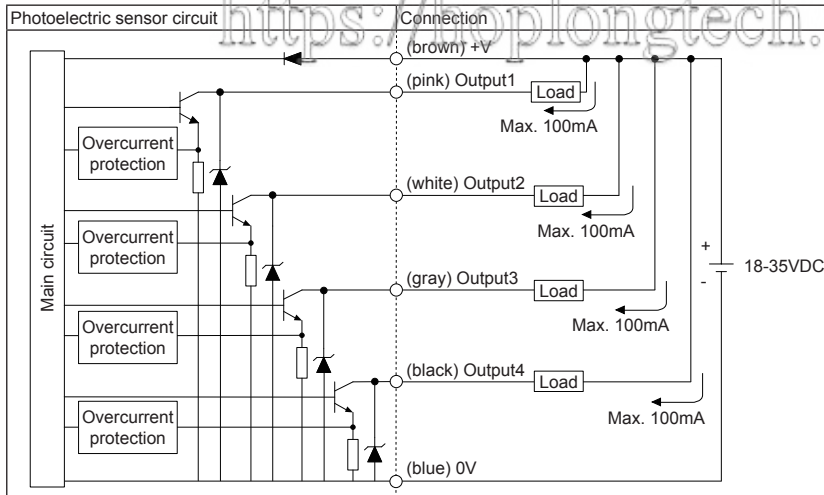

■ Connections

