

Ring Type Current Transformer

Certificates  



Model No

KBJ - 
 

① Size









See the table below

② Use

N/A For Meter (MCT)

R For OCR(PCT)

Selection table

Certi.	Size	For meter(MCT)					For OCR(PCT)			
		Current(A)				Class (%)	Current(A)			Class (IEC)
		2.5VA	5VA	15VA	40VA		2.5VA	5VA	15VA	
	15	40	50~75	-	-	3.0	-	-	-	5P10
		-	100~150	-	-	1.0	-	-	-	
	23	40	50~75	-	-	3.0	-	-	-	
		-	100~200	250~300	-	1.0	-	-	-	
	25	50~60	75	-	-	3.0	-	-	-	
		-	100~200	250~300	-	1.0	-	-	-	
	26	30	40	-	-	3.0	50~150	200~400	-	
		-	50~80	100~150	200~500	1.0				
	03	-	100~150	200~350	400~600	1.0	250~400	500~600	-	
	04	-	100~150	200~350	400~2000	1.0	200~350	400~800	1000~2000	
	06	-	100~200	250~400	500~3000	1.0	-	500~1000	1200~3000	
	10	-	-	300~500	600~6000	1.0	-	500~1000	1200~6000	

 **How to find** Example) KBJ-25 Type is manufactured at 5 VA 1.0 CL within the range from 100 to 200 AT. and in the range of 40AT in 2.5VA 3.0 class.

 **How to order** Example) KBJ-25 100/5, 5VA, 1.0%

 Customized product can be produced by order.

Specification

Secondary current	Overcurrent strength	Maximum voltage	Withstand voltage	Frequency
5A OR 1A	40times	1.15kV	4.0 kV / 1 min	50/60Hz

KBJ-15/KBJ-25

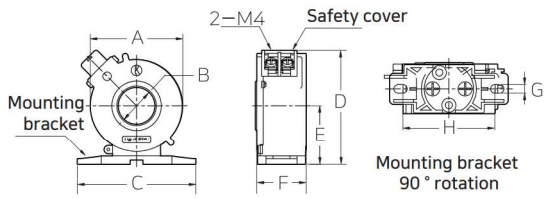

TYPE	A	B	C	D	E	F	G	H	Weight
KBJ-15	66	Φ15	84	83	43	35	6	65	400g
KBJ-25	66	Φ25	84	83	43	35	6	65	320g

KBJ-23/KBJ-26

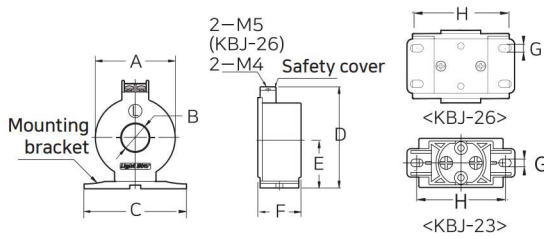

TYPE	A	B	C	D	E	F	G	H	Weight
KBJ-23	65	Φ23	84	89	42	38	6	72	320g
KBJ-26	90	Φ26	100	120	60	60	6	82	2.5kg

KBJ-03

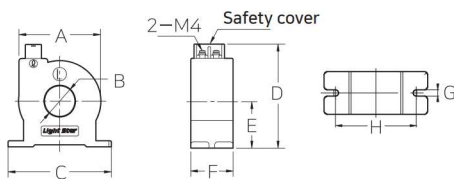

TYPE	A	B	C	D	E	F	G	H	Weight
KBJ-03	80	Φ30	100	100	45	40	6	78	550g

KBJ-04/KBJ-06

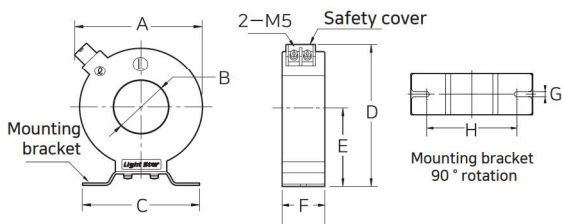

TYPE	A	B	C	D	E	F	G	H	Weight
KBJ-04	102	Φ40	95	117	64	40	5	70	800g
KBJ-06	125	Φ60	120	141	75	40	5	92	1100g

KBJ-10

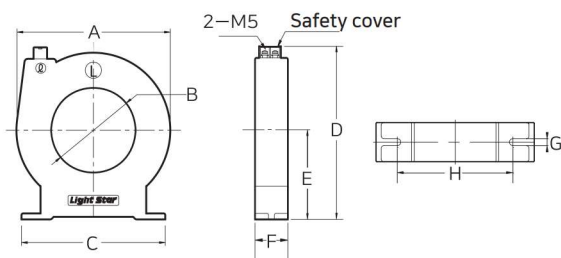

TYPE	A	B	C	D	E	F	G	H	Weight
KBJ-10	182	Φ100	182	203	106	40	6	133	2100g