

Window Type Current Transformer

Optimized design for air circuit breaker

Certificates 











Model No

KBM - 

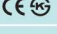

① Size
See the table below

② Use
N/A For meter(MCT)
R For OCR(PCT)

Selection table

Certi.	Size	For meter(MCT)				For OCR(PCT)			
		Current(A)			Class (%)	Current(A)			Class (IEC)
		5VA	15VA	40VA		5VA	15VA	40VA	
	25	100~150	200~350	-	1.0	400	-	-	5P10
	03	120~150	200~350	400~600	1.0	400~600	-	-	
	05	200~300	400~700	750~2000	1.0	1000~2000	-	-	5P10
	08	100~200	250~400	500~2000	1.0	400~500 600~800	1000~2000	-	
	10	200~300	400~500	600~3200	1.0	350~600 700~800	1000~2000	3000~4000	5P10
	12	300~400	500~750	800~3000	1.0	1200~3000	-	-	5P10
	14	-	400~500	600~6000	1.0	-	1000~2500	3000~4000	5P10
	18	-	500~800	1000~8000	1.0	-	1200~2500	3000~5000	5P10
	21	-	500~800	1000~12000	1.0	-	1200~2000	3000~5000	5P10
							2500~5000	6000~8000	5P20

 Customized product can be produced by order.

 **How to find** Example) KBM-25 type is manufactured at 5 VA 1.0 class within the range of 100 to 150 AT.
KBM-08R type is manufactured at 15 VA 5P 10 within the range of 1000-2000 A

 **How to order** Example) KBM-25 100/5. 5VA, 1.0, KBM-08R 1000/5A, 15VA, 5P10

 Customized product can be produced by order.

 Bolt Insulation Cover

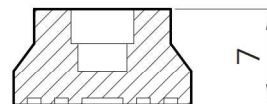
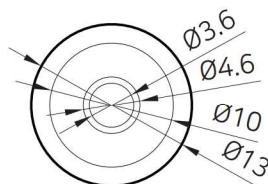

Design can be changed without notice

Specification

Secondary current	Overcurrent strength	Maximum voltage	Withstand voltage	Frequency
5A OR 1A	40times	1.15kV	4.0 kV / 1 min	50/60Hz

Drawing

Unit:mm

KBM-25/03/05/08/10/12 | Torque limit for bus bar fixing bolt : M4 - 5~7 kgf · cm, M5 - 7~10kgf · cm
(Excess torque may cause bending and distortion)

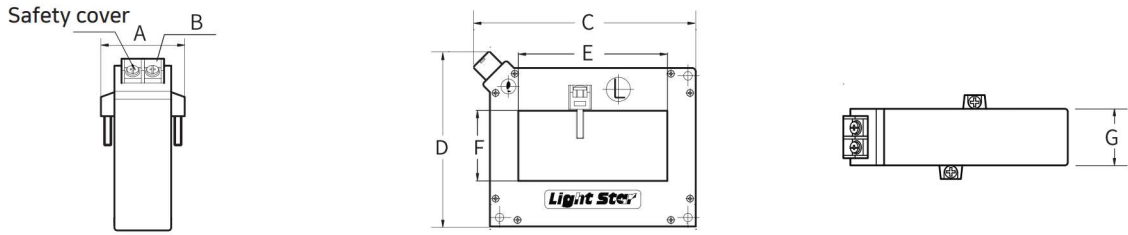

TYPE	A	B	C	D	E	F	G	Weight
KBM-25	74	2-M5	85	65	26	9	55	500g
KBM-03	74	2-M5	100	80	42	10	55	700g
KBM-05	59	2-M5	107	104	61	40	40	800g
KBM-08	74	2-M5	139	95	80	12	55	1000g
KBM-10	74	2-M5	165	120	105	30	55	1300g
KBM-12	59	2-M5	157	121	105	50	40	840g

KBM-14/18/21 | Please be aware that bus bar fixing bolt for current transformer can be energized. Bolt insulation covers are recommended for safety

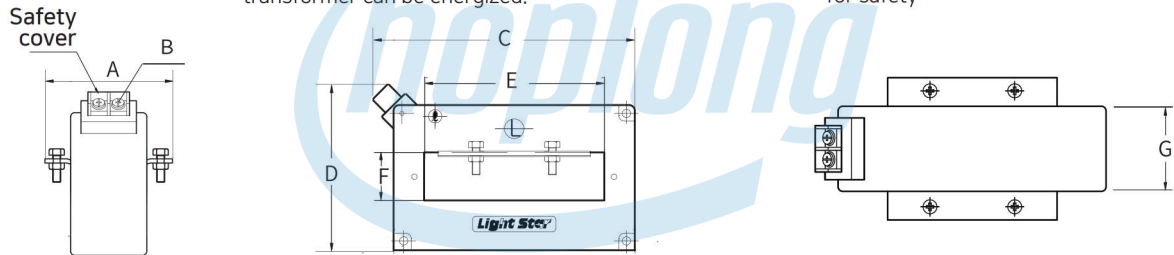

TYPE	A	B	C	D	E	F	G	Weight
KBM-14	92	2-M5	186	116	130	34	55	2000g
KBM-18	92	2-M5	238	131	180	43	55	2700g
KBM-21	92	2-M5	280	179	210	85	55	3200g

1000 /1200AF Circuit breaker

Unit:mm

Circuit breaker

Standard	1000/1200AF
A	34
B	44
C	70

Recommended

Type	KBM-05
A'	40
B'	61
C'	70
D'	118

40VA is order made

Example

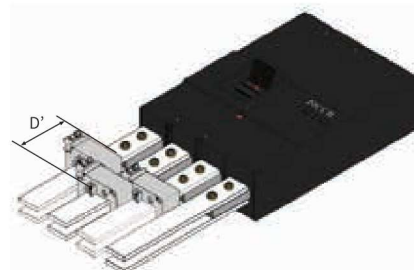
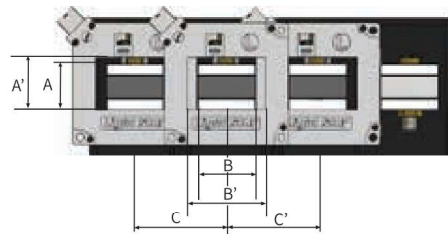

CÔNG TY CỔ PHẦN CÔNG NGHỆ HỢP LONG

Current ratio		Model selection																				
Pri. (A)	Sec. (A)	Busbar type																				
		1P, MCT					1P, PCT					3P, MCT										
		Name	ID	OD	Burden	Accuracy	Name	ID	OD	Burden	Accuracy	Name	ID	C-C	Burden	Accuracy						
50	5	KBM-31	16x7	40.5x40.5	2.5VA	3.0%							KBF-02/03	16x7	25	2.5VA	3.0%					
													KBF-12/13	16x7	30	2.5VA	3.0%					
60	5	KBM-31	16x7	40.5x40.5	2.5VA	3.0%							KBF-02/03	16x7	25	2.5VA	3.0%					
													KBF-12/13	16x7	30	2.5VA	3.0%					
75	5	KBM-31	16x7	40.5x40.5	2.5VA	3.0%							KBF-02/03	16x7	25	2.5VA	3.0%					
		KBM-32	21x10	51.5x43	2.5VA	3.0%							KBF-12/13	16x7	30	2.5VA	3.0%					
100	5	KBM-31	16x7	40.5x40.5	5VA	3.0%							KBF-02/03	16x7	25	2.5VA	3.0%					
		KBM-32	21x10	51.5x43	2.5VA	3.0%							KBF-12/13	16x7	30	2.5VA	3.0%					
120	5	KBM-32	21x10	51.5x43	2.5VA	3.0%							KBF-12/13	16x7	30	5VA	3.0%					
		KBM-34	32x12	62x60	5VA	1.0%							KBF-22/23	21x10	35	5VA	3.0%					
150	5	KBM-32	21x10	51.5x43	5VA	3.0%							KBF-12/13	16x7	30	5VA	3.0%					
		KBM-34	32x12	62x60	5VA	1.0%							KBF-22/23	21x10	35	5VA	3.0%					
200	5	KBM-32	21x10	51.5x43	5VA	1.0%							KBF-12/13	16x7	30	5VA	1.0%					
		KBM-34	32x12	62x60	15VA	1.0%							KBF-22/23	21x10	35	5VA	1.0%					
250	5	KBM-32	21x10	51.5x43	5VA	1.0%							KBF-22/23	21x10	35	5VA	1.0%					
		KBM-34	32x12	62x60	15VA	1.0%							KBF-42/43	32x20	44	5VA	1.0%					
300	5	KBM-34	32x12	62x60	15VA	1.0%	KBM-36R	46x20	92x82	2.5VA	5P10			KBF-22/23	21x10	35	5VA	1.0%				
		KBM-36	46x20	92x82	15VA	1.0%								KBF-42/43	32x20	44	5VA	1.0%				
400	5	KBM-34	32x12	62x60	15VA	1.0%	KBM-36R	46x20	92x82	2.5VA	5P10			KBF-42/43	32x20	44	5VA	1.0%				
		KBM-36	46x20	92x82	40VA	1.0%								KBF-62/63	46x25	70	15VA	1.0%				
500	5	KBM-36	46x20	92x82	40VA	1.0%	KBM-36R	46x20	92x82	5VA	5P10			KBF-42/43	32x20	44	15VA	1.0%				
		KBM-05	60x40	107x104	15VA	1.0%								KBF-62/63	46x25	70	15VA	1.0%				
600	5	KBM-36	46x20	92x82	40VA	1.0%	KBM-36R	46x20	92x82	5VA	5P10			KBF-62/63	46x25	70	15VA	1.0%				
		KBM-05	60x40	107x104	15VA	1.0%								KBF-72/73	69x41	90.5	15VA	1.0%				
750	5	KBM-36	46x20	92x82	40VA	1.0%	KBM-36R	46x20	92x82	5VA	5P10			KBF-62/63	46x25	70	15VA	1.0%				
		KBM-05	60x40	107x104	40VA	1.0%								KBF-72/73	69x41	90.5	15VA	1.0%				
800	5	KBM-36	46x20	92x82	40VA	1.0%	KBM-36R	46x20	92x82	5VA	5P10			KBF-62/63	46x25	70	15VA	1.0%				
		KBM-05	60x40	107x104	40VA	1.0%								KBF-72/73	69x41	90.5	40VA	1.0%				
1000	5	KBM-05	60x40	107x104	40VA	1.0%	KBM-05R	60x40	107x104	5VA	5P10			KBF-62/63	46x25	70	15VA	1.0%				
		KBM-10	105x30	165x120	40VA	1.0%								KBM-10R	105x30	165x120	15VA	5P10	KBF-72/73	69x41	90.5	40VA
1200	5	KBM-05	60x40	107x104	40VA	1.0%	KBM-05R	60x40	107x104	5VA	5P10			KBF-62/63	46x25	70	15VA	1.0%				
		KBM-10	105x30	165x120	40VA	1.0%								KBM-10R	105x30	165x120	15VA	5P10	KBF-72/73	69x41	90.5	40VA
1500 (1600)	5	KBM-05	60x40	107x104	40VA	1.0%	KBM-05R	60x40	107x104	5VA	5P10			KBF-72/73	69x41	90.5	40VA	1.0%				
		KBM-10	105x30	165x120	40VA	1.0%								KBM-10R	105x30	165x120	15VA	5P10				
2000	5	KBM-12	105x50	157x121	40VA	1.0%	KBM-12R	105x50	157x121	5VA	5P10			KBF-72/73	69x41	90.5	40VA	1.0%				
		KBM-14	130x34	186x116	40VA	1.0%								KBM-14R	130x34	186x116	15VA	5P10				
2500	5	KBM-12	105x50	157x121	40VA	1.0%	KBM-12R	105x50	157x121	5VA	5P10											
		KBM-14	130x34	186x116	40VA	1.0%								KBM-14R	130x34	186x116	15VA	5P10				
		KBM-18	180x43	238x131	40VA	1.0%								KBM-18R	180x43	238x131	15VA	5P10				
3000	5	KBM-12	105x50	157x121	40VA	1.0%	KBM-12R	105x50	157x121	5VA	5P10											
		KBM-14	130x34	186x116	40VA	1.0%								KBM-14R	130x34	186x116	15VA	5P20				
4000 over	5	KBM-14	130x34	186x116	40VA	1.0%	KBM-14R	130x34	186x116	15VA	5P20											
		KBM-18	180x43	238x131	40VA	1.0%								KBM-18R	180x43	238x131	40VA	5P10				
		KBM-21	210x85	280x179	40VA	1.0%								KBM-21R	210x85	280x179	40VA	5P10				

Recommended CT per ACB type

LSIS

Rated current	Frame / ACB Terminal	Bus bar size	CT No.
200A	1600AF AN-D	5tX50X1EA	KBM-05
400A		5tX50X2EA	
630A		10tX60X1EA	
800A		6tX50X2EA	
1000A	AS-D	10tX60X1EA	KBM-05
1250A	15tX50X1EA	8tX50X2EA	
		6tX75X2EA	
		8tX50X2EA	
1600A	15tX50X1EA	10tX50X2EA	KBM-05
		6tX75X3EA	
		8tX60X3EA	
2000A	2000AF	8tX75X3EA	KBM-12
	AS-D	10tX100X2EA	②KBM-12
630A	15tX50X1EA	5tX50X2EA	KBM-05
		10tX60X1EA	
800A	15tX50X1EA	6tX50X2EA	KBM-05
		10tX60X1EA	
1000A	15tX50X1EA	8tX50X2EA	KBM-05
1250A		6tX75X2EA	
1600A	15tX50X1EA	8tX60X2EA	KBM-05
		10tX50X2EA	
2000A	15tX50X1EA	8tX75X3EA	KBM-12
		10tX100X2EA	
630A	15tX50X1EA	5tX50X2EA	KBM-05
		10tX60X1EA	
800A	15tX50X1EA	6tX50X2EA	KBM-05
		10tX60X1EA	
1000A	15tX50X1EA	8tX50X2EA	KBM-05
		6tX75X2EA	
1250A	15tX50X1EA	8tX60X2EA	KBM-05
		10tX50X2EA	
1600A	15tX50X1EA	8tX75X3EA	KBM-12
		10tX60X2EA	
2000A	15tX50X1EA	8tX60X3EA	KBM-05
		8tX75X3EA	
2500A	15tX50X1EA	10tX100X2EA	KBM-12
		10tX75X3EA	
3200A	15tX50X1EA	8tX75X4EA	①KBM-21
		10tX100X3EA	
4000A	15tX50X1EA	10tX75X4EA	②KBM-12
		10tX100X4EA	
4000A	15tX50X1EA	10tX75X5EA	KBM-18
		10tX100X4EA	
4000A	5000AF	10tX100X4EA	KBM-18
5000A	AS-D	10tX125X4EA	
4000A	AS-G	10tX100X4EA	KBM-18
5000A		10tX125X4EA	
6300A	20tX150X2EA	10tX150X4EA	KBM-18

① Busbar bent is recommended for 3P4W

② Busbar bent is recommended

HHI

Rated current	Frame / ACB Terminal	Bus bar size	CT No.
200A	A Frame UAS/UAN	5tX50X1EA	KBM-05
400A		5tX50X2EA	
630A		10tX60X1EA	
800A		6tX50X2EA	
1000A	06-16	10tX60X1EA	KBM-05
1250A	15tX50X1EA	8tX50X2EA	
		6tX75X2EA	
		8tX60X2EA	
1600A	15tX50X1EA	10tX50X2EA	KBM-05
		6tX75X3EA	
		8tX60X3EA	
2000A	A Frame	8tX75X3EA	KBM-12
	UAN20	10tX100X2EA	
630A	15tX75X1EA	5tX50X2EA	KBM-05
		10tX60X1EA	
800A	15tX75X1EA	6tX50X2EA	KBM-05
		10tX60X1EA	
1000A	15tX75X1EA	8tX50X2EA	KBM-12
		6tX75X2EA	
1250A	15tX75X1EA	8tX60X2EA	KBM-05
		10tX50X2EA	
1600A	15tX75X1EA	8tX75X3EA	KBM-12
		10tX60X2EA	
2000A	15tX75X1EA	8tX60X3EA	KBM-12
		8tX75X3EA	
2500A	15tX75X1EA	10tX100X2EA	②KBM-12
		10tX75X3EA	
3200A	15tX75X1EA	8tX75X4EA	①KBM-21
		10tX100X3EA	
4000A	15tX75X1EA	10tX75X4EA	②KBM-12
		10tX100X4EA	
4000A	15tX75X1EA	10tX125X3EA	KBM-18
		10tX100X4EA	
4000A	B Frame	10tX100X4EA	KBM-18
5000A	UAN40	10tX100X3EA	
4000A	UAN40	10tX125X3EA	KBM-18
5000A		10tX100X4EA	
3200A	C Frame	10tX125X3EA	KBM-18
4000A	UAN32-50	10tX100X4EA	
5000A	UAN32-50	10tX125X4EA	KBM-18
6300A		10tX150X4EA	